

# Composite Footvalves

## Features

- All contact parts are 316 stainless steel with PTFE seals
- Butterfly Valve has left hand operation with TIR and a facility for a padlock
- Eccentric Spigot Flange allows optimal flow rates while limiting trapped liquids
- 3" BSP Cap has straight threads that reduce galling when frequently removing and replacing Blanking Cap
- All gaskets, seals and O-Rings are standard sizes, made from PTFE materials, and interchangeable with other major brands
- Optional 316 stainless steel or Hastelloy® replaceable seat available upon request



PART #	DESCRIPTION
GQ72000	3" 45° Valve BSP
GQ70007	3" 30° Valve BSP

PERFORMANCE SPECIFICATIONS	
Design Pressure	4 BAR (58 PSI)
Design Pressure	-20°C to 200°C (-4°F to 392°F)

FUSIBLE LINK OPTIONS	
G-Link	Thermally reactive auto shutoff device.

PRODUCT DIMENSIONS	
Weight	15 kg (33 lbs)

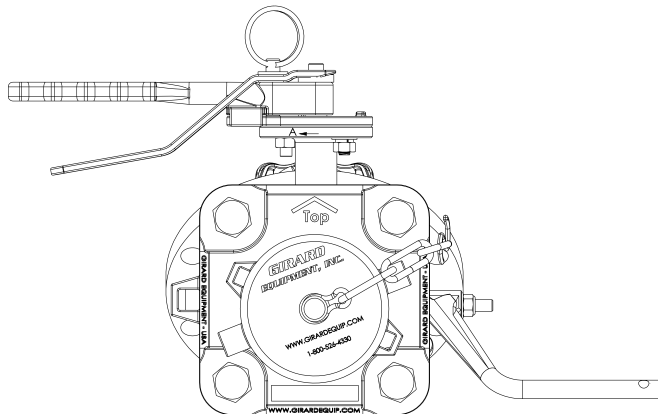

DISCHARGE VIEW

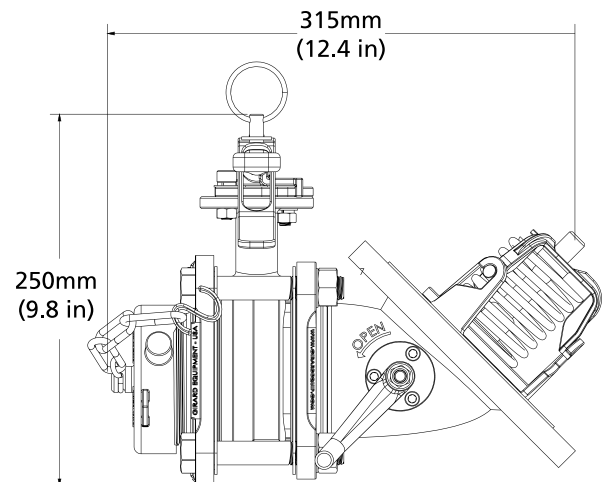

SIDE VIEW

# Composite Footvalves

ITEM	PART #	DIMENSIONS
1	GQ60620	45° Outlet Assembly G3 with Cast Hooks
2	GQ70030	Square Butterfly Inlet Gasket
3	GQ70040	Outlet Flange 3" BSP
4	GQ50000	3" Clamped Butterfly Valve
5	GQ97968	M16 Hex Head Cap Screw
6	GQ97966	M16 Hex Nut
7	GQ97963	M16 Internal Lock Washer
8	GK30100	3" Blanking Cap BSP Thread
9	GK10001	1/8" 316 Stainless Steel "S" Hook
10	GK98010	1/8" 316 Stainless Steel Chain (per metre)



**GM42110**  
Inlet Connection Gasket



**GQ98060**  
8 Stud, Washer Set -  
Stainless Steel



**GK10001**  
Stainless Steel Chain  
(order by the foot or metre)



**GK30100**  
3" Blanking  
Cap (BSP)

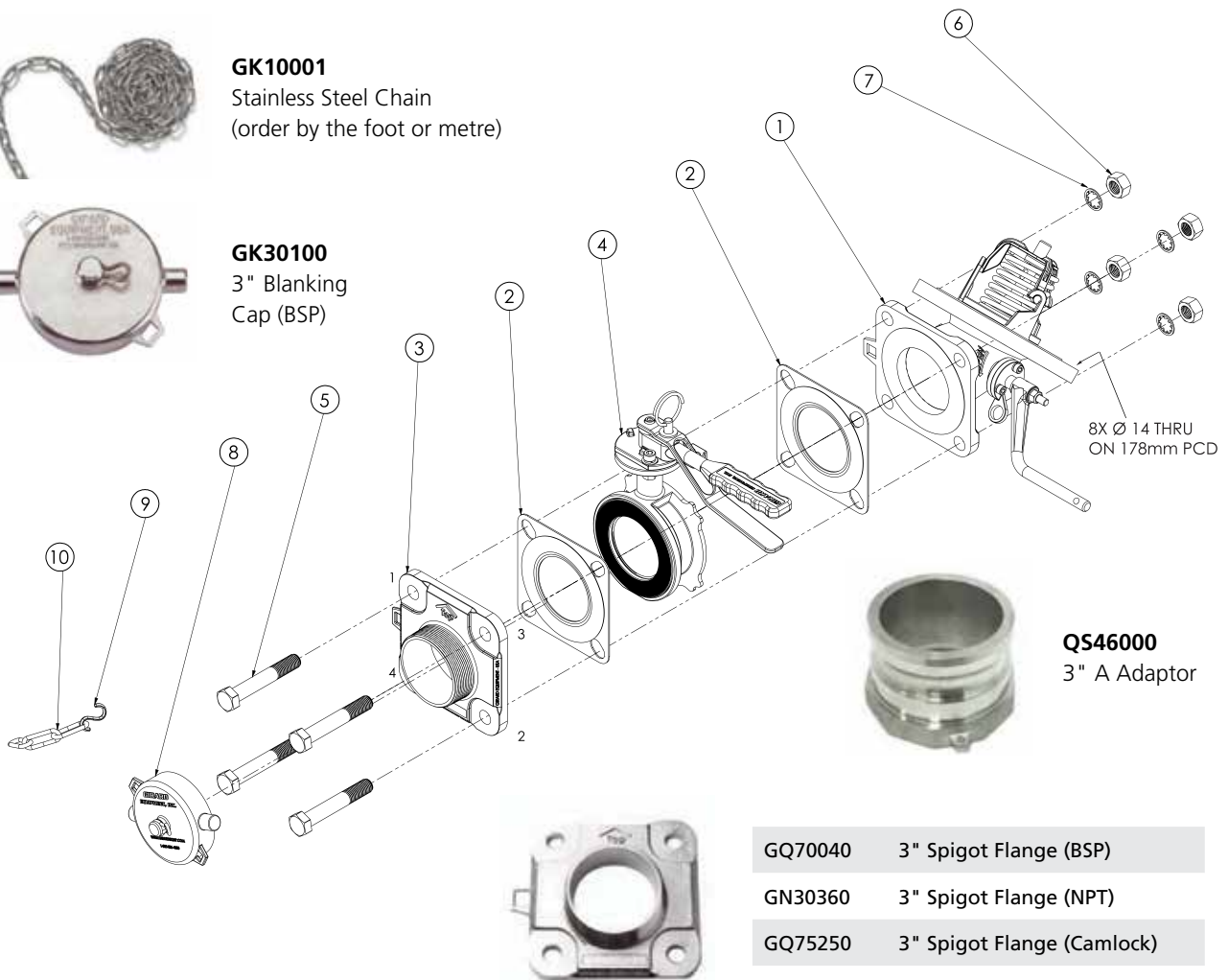

**QS46000**  
3" A Adaptor

**GQ70040** 3" Spigot Flange (BSP)

**GN30360** 3" Spigot Flange (NPT)

**GQ75250** 3" Spigot Flange (Camlock)